

MEKA XPG, THE MORE DURABLE SURFACE

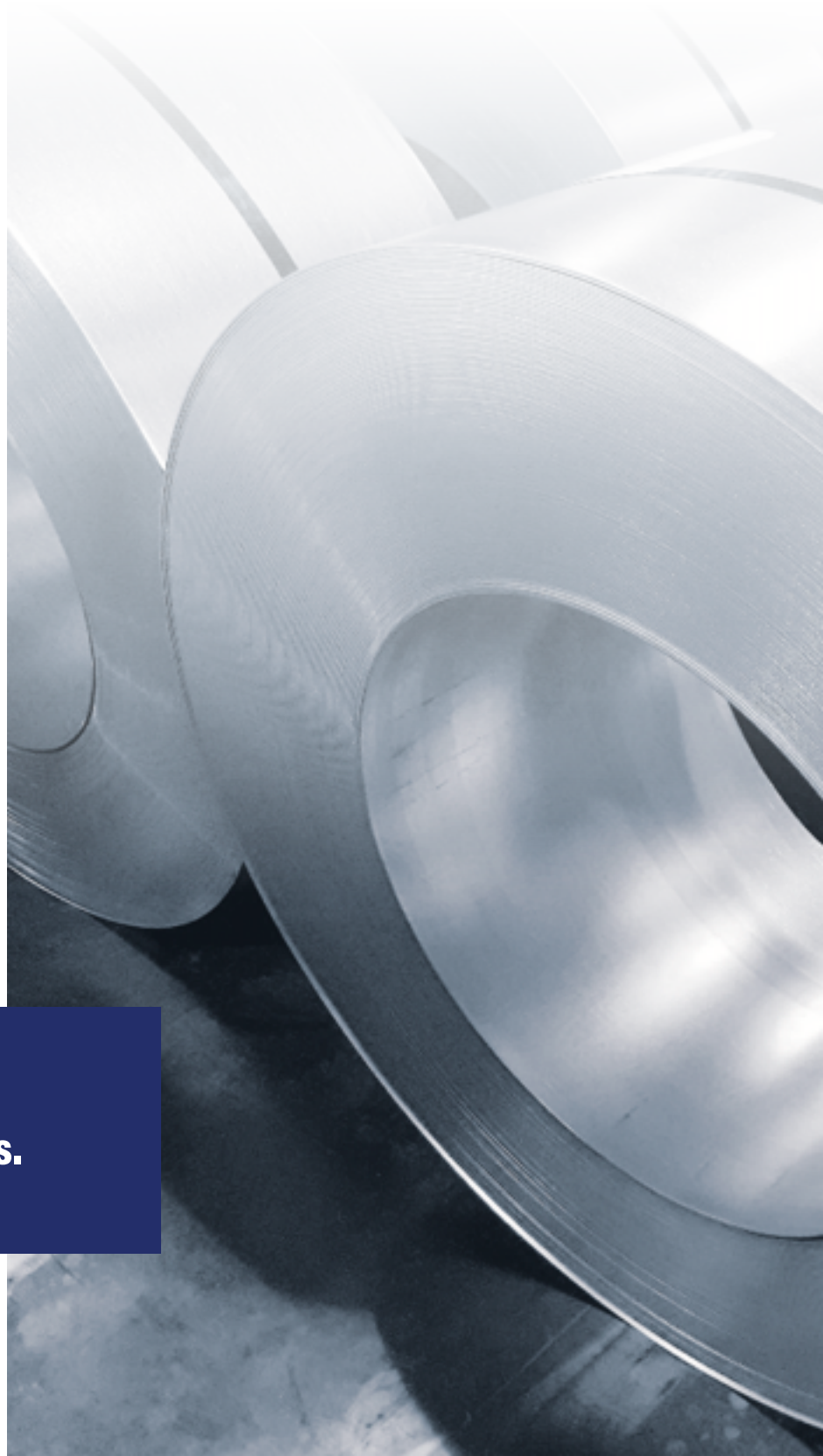

OUR PRODUCT DEVELOPMENT TEAM IS WORKING CONTINUOUSLY FOR FINDING MORE DURABLE AND COST-EFFECTIVE MATERIALS AND SOLUTIONS. **XPG IS ONE OF THE RESULTS OF THIS WORK.**



**New coating.
Tested in extreme conditions.**





NEW FOR ATMOSPHERIC-CORROSIVITY CATEGORY C4

Corrosion of metals has been studied over the years. Environments are classified according to EN ISO 12944 into atmospheric-corrosivity categories from C1 to CX according to the weight loss of the steel in that environment. Meka has options for all atmospheric-corrosivity categories classified in the standard, from C1 to CX.

We have traditionally offered hot-dip galvanized (HDG) products into the atmospheric-corrosivity category C4. Now we are introducing a new competitive and certified corrosion protection, XPG, into atmospheric-corrosivity category C4.

The alloy of the XPG coating contains elements like aluminum. Elements form a thin film on XPG's surface. This dense film improves the corrosion protection capacity of the coating compared to a traditional zinc coating. Corrosion protection of XPG coating is based not only on cathodic protection but also on mechanical protection.

XPG offers the same corrosion protection in alkaline and acidic environments as other zinc-based coatings. In chloride- and ammonia-containing environments, XPG provides clearly better corrosion protection than traditional zinc coating.

The Key Characteristics of XPG coating:

- ✓ Even and hard surface for steel
- ✓ Cathodic and mechanical corrosion protection
- ✓ More durable corrosion protection with a thinner coating
- ✓ Self-healing corrosion protection for e.g. cutting edges and scratches
- ✓ Environmentally-friendly option to corrosion protection
- ✓ Cost-effective substitute for HDG and PURAL.

Self-healing coating for cutting edges

In the manufacture of steel sheet products, coated steel sheets are shaped and cut. With the cut, the coating disappears from the steel surface, and the uncoated cutting surface is prone to corrosion.

XPG coating protects cutting edges with a thin zinc based protective film containing element that prevents corrosive reactions. As the ratio of zinc coating to steel thickness decreases, the zinc's corrosion protection ability of the edge decreases in traditional zinc coating. XPG protects steel product even if this ratio is low.

Option for hot-dip galvanizing

Based on the salt spray tests, XPG coating provides 10-20 times better corrosion protection than the traditional hot-dip galvanizing.

In comparison with the traditional hot-dip galvanizing, XPG enables significant reduction of the coating weight without compromising the corrosion protection characteristics.

Environmentally friendlier choice

We have calculated that XPG contains about 50% less zinc than the traditional Meka HDG products. This itself has a great environmental benefit. The XPG's composition also significantly reduces the zinc leakage to the soil and water. We manufacture XPG-products in one location, which additionally reduces the logistics and transport impact as well as our CO₂ footprint further.

Meka's extensive testing

In addition to the testing provided by the manufacturer of the special XPG coating, we have tested XPG ourselves with five different methods. We wanted to ensure that as XPG coating is formed and applied to our products, it completely fulfills the high demands and specifications.

In Meka's products, XPG has been tested with following methods:

- ✓ **Continuous salt spray test**, ISO 9227, 550h (corresponds IEC 61537 class 6)
- ✓ **Liquid impregnation test**, SFS-EN ISO 3452-1
- ✓ **Field test**, products in hars environment and usage conditions.
- ✓ **Accelerated corrosion test**, VDA 621-415 (cyclic corrosion test)

In addition, we have conducted **bending tests** on XPG coated materials in Finland, at the University of Oulu by bending the material in different radiuses to ensure the bending durability of the coating.

Tests started in spring 2018 and the latest tests of welded structures were completed in spring 2021.



XPG coated lighting support rail MEK after salt spray test.

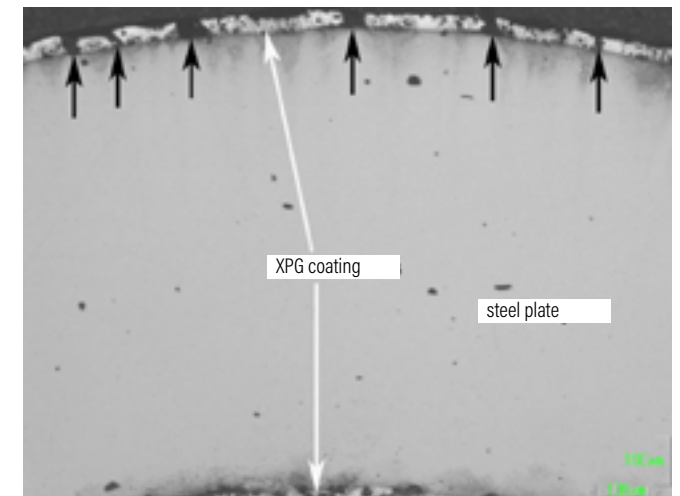

In the bending tests by the University of Oulu, the samples were bended 180 degrees with bending radii $r=1$ mm and $r=3$ mm. The samples were examined under a light microscope. On the compression side of the bend no cracking/distortion were found in the XPG coating.



XPG coated bottom plate POL after a SFS-EN ISO 3452-1 liquid impregnation test. No cracks were found.

Lighting support rails



Lighting support rail MEK 70 K

Lighting support rails MEK 70 K are used for installation of luminaires, cables and other devices in shopping centres, schools, office- and commercial building, parking halls as well as in industrial buildings. Unique profile allows longer spans and use of MEK VM sliding nuts. MEK 70 K are suitable for medium loading capacities.

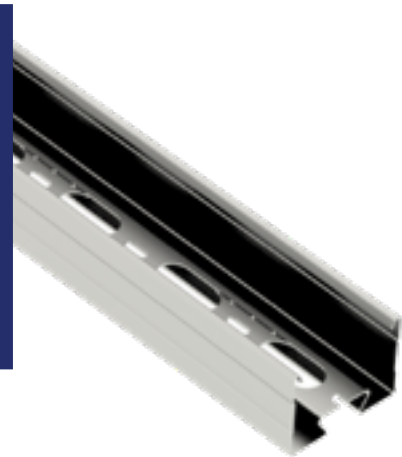

CODE	PRODUCT	WEIGHT kg / pc	L mm	S mm	PACKAGE
1449293	MEK 70 K L=3000 XPG	3.44	3000	0.75	28 PCE / 84 MTR
1449296	MEK 70 K L=6000 XPG	6.88	6000	0.75	28 PCE / 168 MTR
XPG	Manufactured of coated steel in accordance with standard EN 10346 : C1-C4				

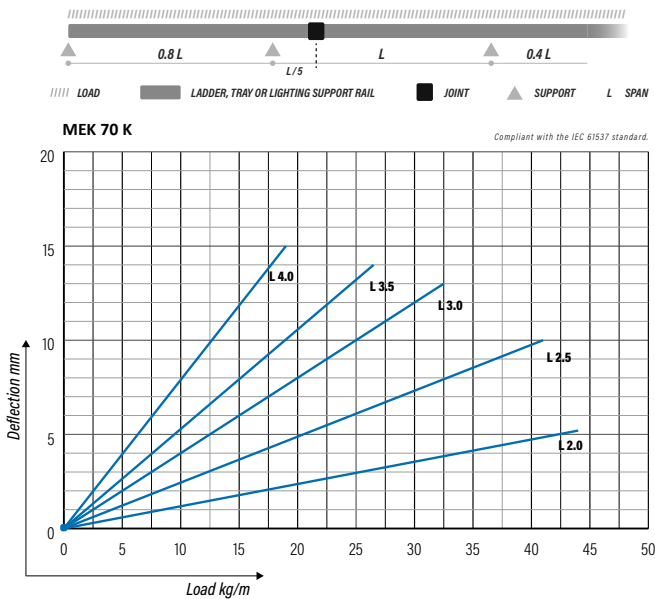
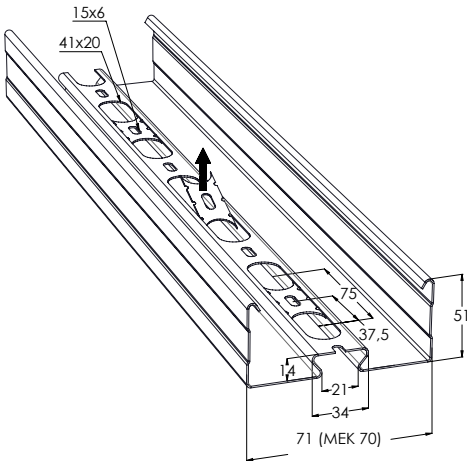
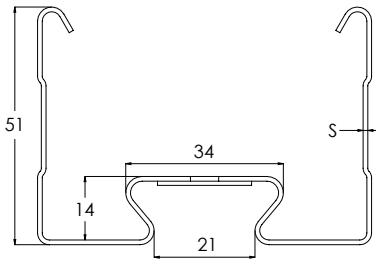

Joint MEK J

Joints MEK J are used to extend MEK 70 K XPG lighting support rails.

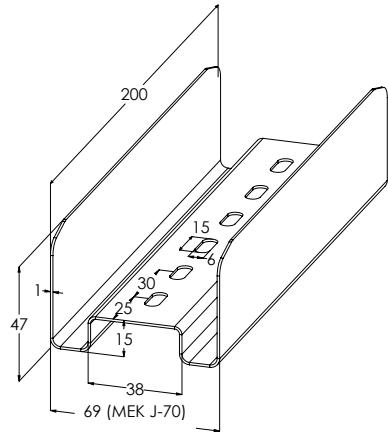
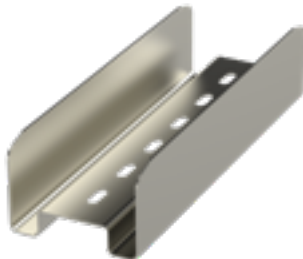

CODE	PRODUCT	WEIGHT kg / pc	PACKAGE
1449288	MEK J-70 XPG	0.27	10 PCE
XPG	Manufactured of coated steel in accordance with standard EN 10346 : C1-C4		
Product includes screw set: 1449108 RS MEK J 10 EG (2 PCE)			

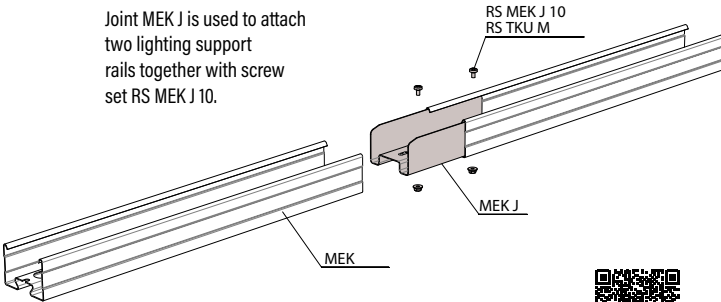

See installation video.

Intermediate support MEK RK

Intermediate supports MEK RK are used to support MEK 70 K XPG lighting support rails into ceiling from inside with threaded rods GT.

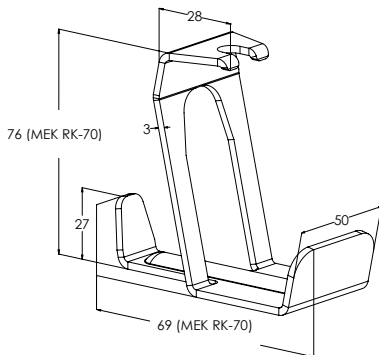

CODE	PRODUCT	WEIGHT kg / pc	LOAD max. kg	PACKAGE
1449358	MEK RK-70 XPG	0.15	50	10 PCE
XPG	Manufactured of coated steel in accordance with standard EN 10346 : C1-C4			

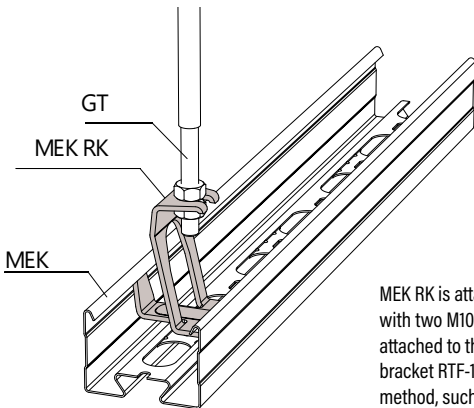

MEK RK is attached to threaded rod GT-10 with two M10 nuts. The threaded rod is attached to the ceiling with either ceiling bracket RTF-10 or another, appropriate method, such as an expansion bolt. Once the ceiling suspension is in place, the lighting support rail can be installed to the intermediate support.

Lighting bracket MEK AH

Lighting brackets MEK AH are used for mounting luminaires and other devices to MEK 70 K XPG lighting support rails.

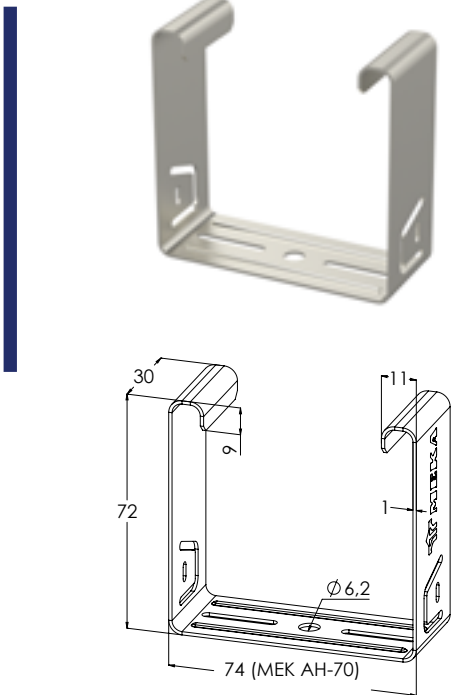

End plate MEK P

End plates MEK P are used to finish the installation and cover ends of MEK 70 K XPG lighting support rails.

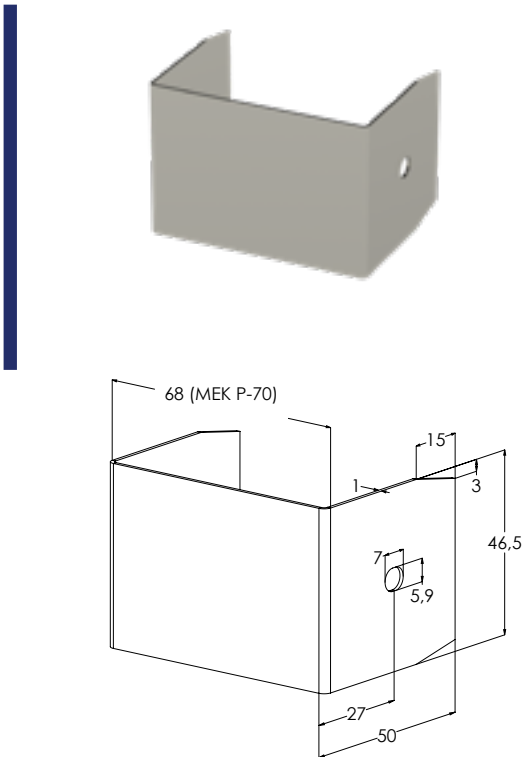

CODE	PRODUCT	WEIGHT kg / pc	LOAD max. kg	PACKAGE
1449277	MEK AH-70 XPG	0.072	10	10 PCE
XPG	Manufactured of coated steel in accordance with standard EN 10346 : C1-C4			

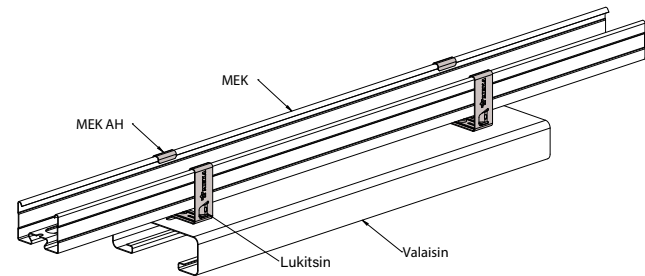

Lighting bracket MEK AH is attached to the light's body, after which it can be attached to the lighting support rail. The lighting bracket can be locked in place by twisting the locking flanges flush with the bracket.



See installation video.

CODE	PRODUCT	WEIGHT kg / pc	PACKAGE
1449280	MEK P-70 XPG	0.051	10 PCE
XPG	Manufactured of coated steel in accordance with standard EN 10346 : C1-C4		

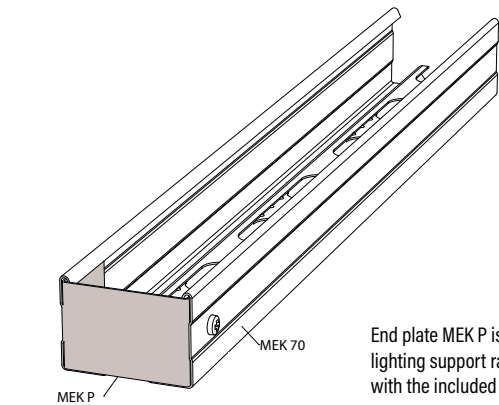

End plate MEK P is used at the ends of a lighting support rail. MEK P is installed with the included screw set.



Cover MEK KA

Covers MEK KA are used to protect the cables from damage, dirt and UV radiation as well as to finish the installation.

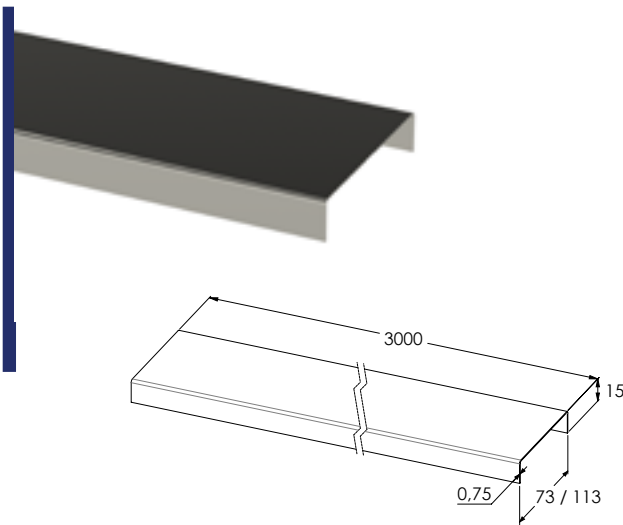

Mounting plate RDP

Mounting plates RDP are used to mount junction boxes and other devices to MEK 70 K XPG lighting supports rails.

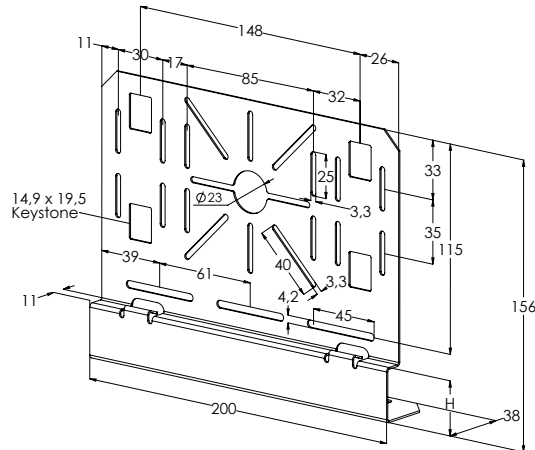

CODE	PRODUCT	WEIGHT kg / pc	PACKAGE
1449290	MEK KA-70 L=3000 XPG	1.67	10 PCE / 30 MTR
XPG	Manufactured of coated steel in accordance with standard EN 10346 : C1-C4		

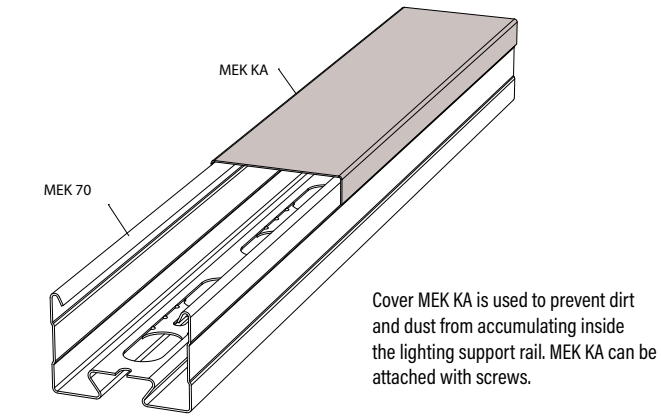

CODE	PRODUCT	WEIGHT kg / pc	PACKAGE
1431652	RDP-40 XPG	0.28	10 PCE
XPG	Manufactured of coated steel in accordance with standard EN 10346 : C1-C4		

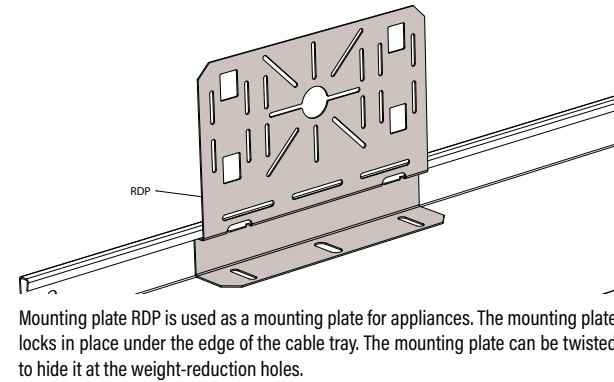

Mounting plate RDP-O



Mounting plates RDP-O are used to mount junction boxes and other devices to MEK 70 K XPG lighting supports rails.



CODE	PRODUCT	WEIGHT kg / pc	PACKAGE
1431653	RDP-O-40 XPG	0.3	10 PCE
XPG	Manufactured of coated steel in accordance with standard EN 10346 : C1-C4		

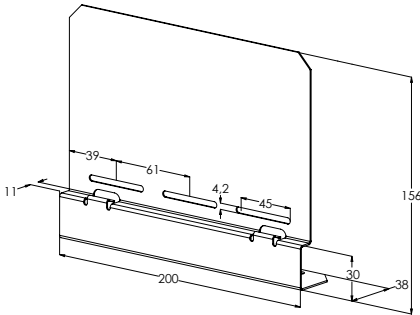

Cable ladders accessories

Cover KRL-KS

Covers KRL-KS protect the cables from damage, dirt and UV radiation as well as finishes the installation for straight sections of cable ladders.

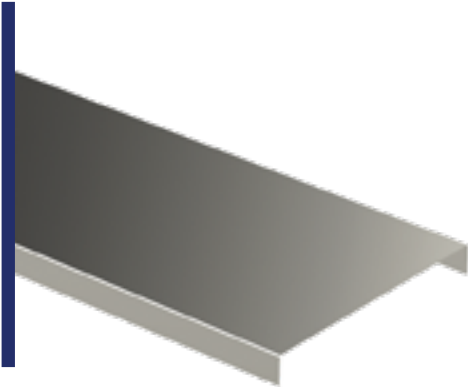

CODE	PRODUCT	WEIGHT kg / pc	A mm	L mm	PACKAGE
1433311	KRL-KS-150 L=3000 XPG	5.06	152	3000	10 PCE / 30 MTR
1433312	KRL-KS-200 L=3000 XPG	6.22	202	3000	10 PCE / 30 MTR
1433313	KRL-KS-300 L=3000 XPG	8.53	302	3000	10 PCE / 30 MTR
1433314	KRL-KS-400 L=3000 XPG	10.85	402	3000	10 PCE / 30 MTR
1433315	KRL-KS-500 L=3000 XPG	13.04	502	3000	10 PCE / 30 MTR
1433316	KRL-KS-600 L=3000 XPG	15.33	602	3000	10 PCE / 30 MTR
XPG	Manufactured of coated steel in accordance with standard EN 10346 : C1-C4				

Cover KRL-KS is used to prevent dirt and dust from accumulating on the cables. The cover is attached to the cable ladder with screws.

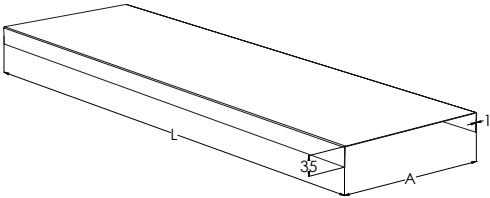
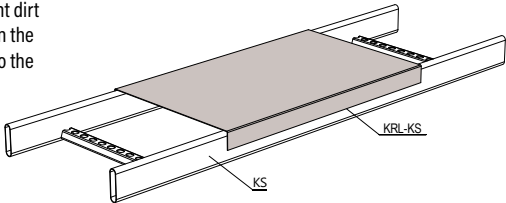

It is possible to increase the cable space under the cover by 50mm with cover bracket KAP. Recommended installation gap 1-1.5m, depending on the width of the cover.

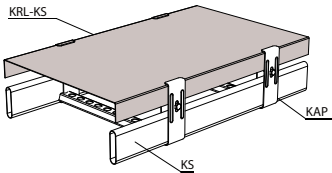

Cover KRL-KS90



Covers KRL-KS90 protect cables from damage, dirt and UV radiation as well as finishes the installation for KS90 bends. KRL-KS90 covers' inside radius options are R=100 mm, R=300 mm, R=600 mm and R=1000 mm.



Product available to order with radius R=1000mm.

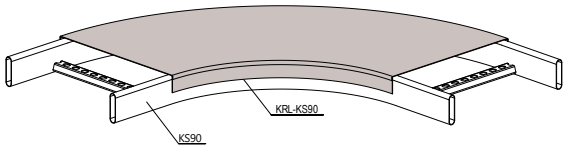
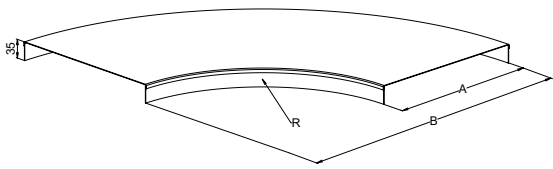

Cover KRL-KS90 is used to prevent dirt and dust from accumulating on the cables. The cover is attached to the cable ladder with screws.

CODE	PRODUCT	WEIGHT kg / pc	A mm	B mm	R mm	PACKAGE
1433321	KRL-KS90-200 R=100 XPG	0.71	205	305	100	10 PCE
1433322	KRL-KS90-300 R=100 XPG	1.19	305	405	100	10 PCE
1433323	KRL-KS90-400 R=100 XPG	1.76	405	505	100	10 PCE
1433324	KRL-KS90-500 R=100 XPG	2.52	505	605	100	10 PCE
1433325	KRL-KS90-600 R=100 XPG	3.37	605	705	100	10 PCE
1433326	KRL-KS90-150 R=300 XPG	1.09	155	454	300	10 PCE
1433327	KRL-KS90-200 R=300 XPG	1.41	205	505	300	10 PCE
1433328	KRL-KS90-300 R=300 XPG	2.14	305	605	300	10 PCE
1433329	KRL-KS90-400 R=300 XPG	2.99	405	705	300	10 PCE
1433330	KRL-KS90-500 R=300 XPG	3.96	505	805	300	10 PCE
1433331	KRL-KS90-600 R=300 XPG	5.06	605	905	300	10 PCE
1433336	KRL-KS90-150 R=600 XPG	1.92	155	740	600	10 PCE
1433337	KRL-KS90-200 R=600 XPG	2.41	205	790	600	10 PCE
1433338	KRL-KS90-300 R=600 XPG	3.49	305	890	600	10 PCE
1433339	KRL-KS90-400 R=600 XPG	4.69	405	990	600	10 PCE
1433340	KRL-KS90-500 R=600 XPG	6.01	505	1090	600	10 PCE
1433341	KRL-KS90-600 R=600 XPG	7.46	605	1190	600	10 PCE
1433346	KRL-KS90-150 R=1000 XPG	3.04	155	1124	1000	10 PCE
1433347	KRL-KS90-200 R=1000 XPG	3.77	205	1174	1000	10 PCE
1433348	KRL-KS90-300 R=1000 XPG	5.32	305	1275	1000	10 PCE
1433349	KRL-KS90-400 R=1000 XPG	6.99	405	1375	1000	10 PCE
1433350	KRL-KS90-500 R=1000 XPG	8.78	505	1475	1000	10 PCE
1433351	KRL-KS90-600 R=1000 XPG	10.7	605	1575	1000	10 PCE
XPG	Manufactured of coated steel in accordance with standard EN 10346 : C1-C4					

Cover KRL-KS45

Covers KRL-KS45 protect cables from damage, dirt and UV radiation as well as finishes the installation for KS45 bends. KRL-KS45 covers' inside radius is R=300 mm.

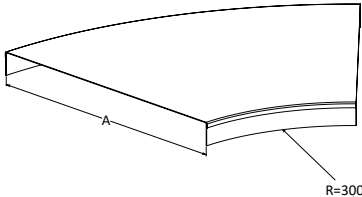
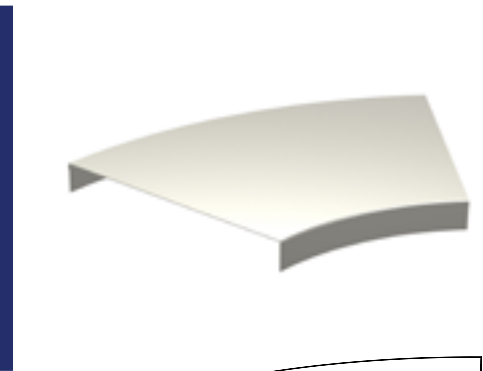

CODE	PRODUCT	WEIGHT kg / pc	A mm	R mm	PACKAGE
1433467	KRL-KS45-150 R=300 XPG	0.55	155	300	10 PCE
1433468	KRL-KS45-200 R=300 XPG	0.71	205	300	10 PCE
1433469	KRL-KS45-300 R=300 XPG	1.1	305	300	10 PCE
1433470	KRL-KS45-400 R=300 XPG	1.51	405	300	10 PCE
1433471	KRL-KS45-500 R=300 XPG	2	505	300	10 PCE
1433472	KRL-KS45-600 R=300 XPG	2.55	605	300	10 PCE
XPG	Manufactured of coated steel in accordance with standard EN 10346 : C1-C4				

Cover KRL-KST



Covers KRL-KST protect cables from damage, dirt and UV radiation as well as finishes the installation for KST pieces. KRL-KST covers’ inside radius options are R=100 mm, R=300 mm, R=600 mm and R=1000 mm.

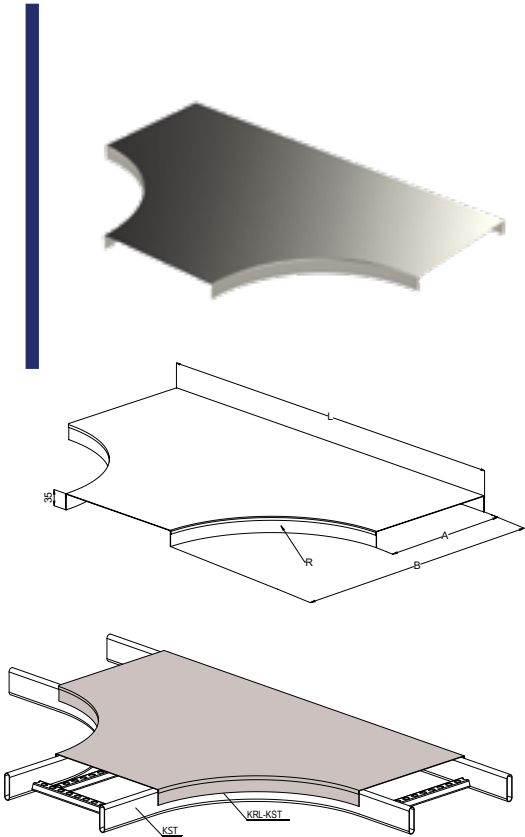

Cover KRL-KST is used to prevent dirt and dust from accumulating on the cables. The cover is attached to the cable ladder with screws.

Cover KRL-KSX

Covers KRL-KSX protect cables from damage, dirt and UV radiation as well as finishes the installation for KSX pieces. KRL-KSX covers inside radius is R=300 mm.

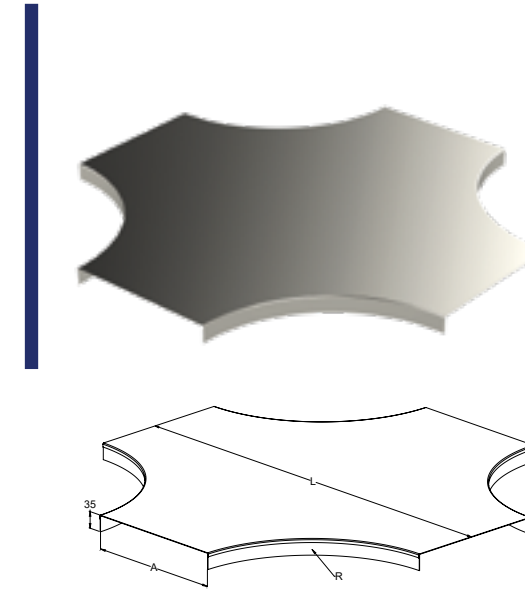

CODE	PRODUCT	WEIGHT kg / pc	A mm	L mm	R mm	PACKAGE
1433378	KRL-KSX-150 R=300 XPG	2.82	155	750	300	10 PCE
1433379	KRL-KSX-200 R=300 XPG	3.42	205	800	300	10 PCE
1433380	KRL-KSX-300 R=300 XPG	4.75	305	900	300	10 PCE
1433381	KRL-KSX-400 R=300 XPG	6.23	405	1000	300	10 PCE
1433382	KRL-KSX-500 R=300 XPG	7.87	505	1100	300	10 PCE
1433383	KRL-KSX-600 R=300 XPG	9.66	605	1200	300	10 PCE
XPG	Manufactured of coated steel in accordance with standard EN 10346 : C1-C4					

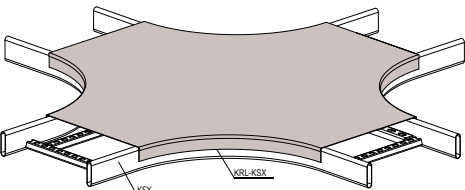

Cover KRL-KSX is used to prevent dirt and dust from accumulating on the cables. The cover is attached to the cable ladder with screws.

Cover KRL-KSV



Vertical bend covers KRL-KSV protect cables from damage, dirt and UV radiation as well as finishes the installation for KSV bends. KRL-KSV covers’ inside radius is R=300 mm.

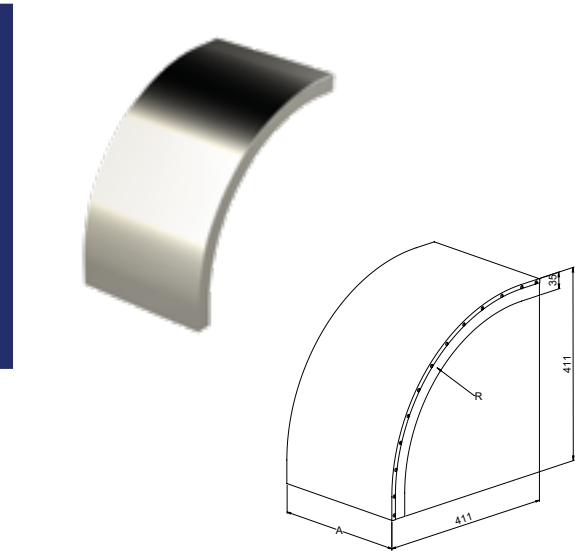

CODE	PRODUCT	WEIGHT kg / pc	A mm	R mm	PACKAGE
1433388	KRL-KSV-150 R=300 XPG	1.03	152	300	4 PCE
1433389	KRL-KSV-200 R=300 XPG	1.25	202	300	4 PCE
1433390	KRL-KSV-300 R=300 XPG	1.68	302	300	4 PCE
1433391	KRL-KSV-400 R=300 XPG	2.12	402	300	4 PCE
1433392	KRL-KSV-500 R=300 XPG	2.56	502	300	4 PCE
1433393	KRL-KSV-600 R=300 XPG	2.99	602	300	4 PCE
XPG	Manufactured of coated steel in accordance with standard EN 10346 : C1-C4				

Cover KRL-KSVI

Vertical bend covers KRL-KSVI protect cables from damage, dirt and UV radiation as well as finishes the installation for KSVI bends. KRL-KSVI covers’ inside radius is R=300 mm.

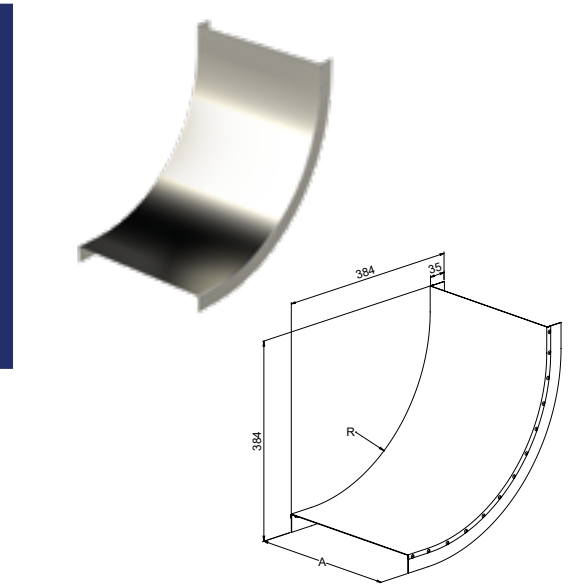

CODE	PRODUCT	WEIGHT kg / pc	A mm	R mm	PACKAGE
1433394	KRL-KSVI-150 R=300 XPG	1.2	152	300	4 PCE
1433395	KRL-KSVI-200 R=300 XPG	1.23	202	300	4 PCE
1433396	KRL-KSVI-300 R=300 XPG	1.94	302	300	4 PCE
1433397	KRL-KSVI-400 R=300 XPG	1.99	402	300	4 PCE
1433398	KRL-KSVI-500 R=300 XPG	2.9	502	300	4 PCE
1433399	KRL-KSVI-600 R=300 XPG	2.98	602	300	4 PCE
XPG	Manufactured of coated steel in accordance with standard EN 10346 : C1-C4				

Covers are used to prevent dirt and dust from accumulating on the cables. The cover is attached to the cable ladder with screws.

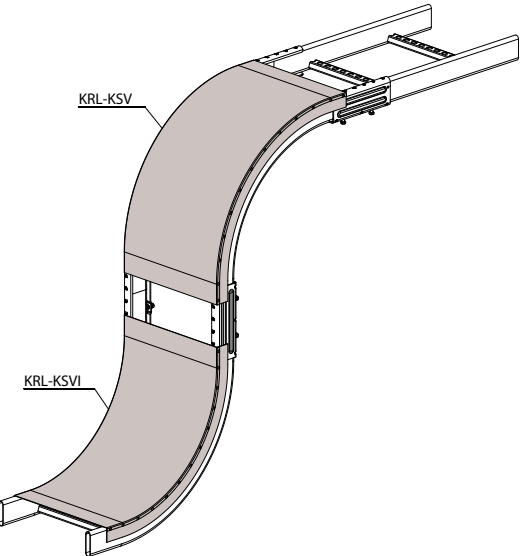

Joint cover KRL-J



Joint covers KRL-J are used to cover cable ladders' KRL-type covers at junction place gap.

CODE	PRODUCT	WEIGHT kg / pc	A mm	B mm	PACKAGE
1433457	KRL-J-150 XPG	0.38	155	304	10 PCE
1433458	KRL-J-200 XPG	0.47	205	304	10 PCE
1433459	KRL-J-300 XPG	0.64	305	304	10 PCE
1433460	KRL-J-400 XPG	0.82	405	304	10 PCE
1433461	KRL-J-500 XPG	0.99	505	304	10 PCE
1433462	KRL-J-600 XPG	1.16	605	304	10 PCE
XPG	Manufactured of coated steel in accordance with standard EN 10346 : C1-C4				

The joint cover KRL-J is attached on top of the cover joint.

Cover SK

Strong covers SK are used to mount vertically and protect cable ladders and cables from impacts and other mechanical damages.

CODE	PRODUCT	WEIGHT kg / pc	A mm	L mm	PACKAGE
1433421	SK-150 L=1550 XPG	4.75	152	1550	1 PCE / 1,55 MTR
1433422	SK-200 L=1550 XPG	5.54	202	1550	1 PCE / 1,55 MTR
1433423	SK-300 L=1550 XPG	7.32	302	1550	1 PCE / 1,55 MTR
1433424	SK-400 L=1550 XPG	9.1	402	1550	1 PCE / 1,55 MTR
1433425	SK-500 L=1550 XPG	10.87	502	1550	1 PCE / 1,55 MTR
1433426	SK-600 L=1550 XPG	12.65	602	1550	1 PCE / 1,55 MTR
XPG	Manufactured of coated steel in accordance with standard EN 10346 : C1-C4				

Cover SK can be used in vertical angles.

It is possible to increase the cable space under the cover by 50mm with cover bracket KAP. Recommended installation gap 1-1.5m, depending on the width of the cover.

Cover SK is used to prevent dirt and dust from accumulating on the cables. The cover is attached to the cable ladder with screws.

Cover PSK



Cable-top covers PSK protect the cables from damage, dirt and UV radiation as well as finishes the installation for straight cable ladders' sections.

CODE	PRODUCT	WEIGHT kg / pc	A mm	B mm	PACKAGE
1433411	PSK-150 L=3000 XPG	5.68	153	80	10 PCE / 30 MTR
1433412	PSK-200 L=3000 XPG	6.6	203	80	10 PCE / 30 MTR
1433413	PSK-300 L=3000 XPG	9.05	303	100	10 PCE / 30 MTR
1433414	PSK-400 L=3000 XPG	11.14	403	100	10 PCE / 30 MTR
1433415	PSK-500 L=3000 XPG	13.31	503	100	10 PCE / 30 MTR
1433416	PSK-600 L=3000 XPG	15.52	603	100	10 PCE / 30 MTR
XPG	Manufactured of coated steel in accordance with standard EN 10346 : C1-C4				

Cover PSK is used to prevent dirt and dust from accumulating on the cables. The cover is attached to the cable ladder with screws.

It is possible to increase the cable space under the cover by 50mm with cover bracket KAP. Recommended installation gap 1-1.5m, depending on the width of the cover.

Bottom plate POL



Bottom plates POL provide visual cover and protect cables from dents from below in cable ladders’ straight sections.

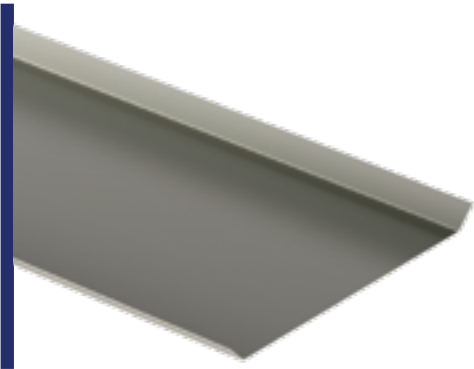

CODE	PRODUCT	WEIGHT kg / pc	A mm	PACKAGE
1433431	POL-200 L=3000 XPG	3.1	168	1 PCE / 3 MTR
1433432	POL-300 L=3000 XPG	4.82	268	1 PCE / 3 MTR
1433433	POL-400 L=3000 XPG	6.55	368	1 PCE / 3 MTR
1433434	POL-500 L=3000 XPG	8.26	468	1 PCE / 3 MTR
1433435	POL-600 L=3000 XPG	9.98	568	1 PCE / 3 MTR
XPG	Manufactured of coated steel in accordance with standard EN 10346 : C1-C4			

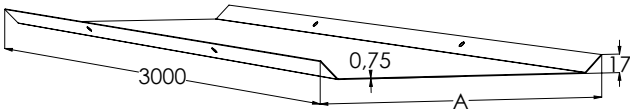

Gate support PRT

Universal gate supports PRT are used as gate or intermediate supports for cable ladders, cable trays and wire mesh trays. Can be mounted to the ceiling with one or two threaded rods GT, depending on loading division and width of cable ladders or -trays.



CODE	PRODUCT	WEIGHT kg / pc	A mm	PACKAGE
1433448	PRT-200 XPG	0.21	250	20 PCE
1433449	PRT-300 XPG	0.3	350	20 PCE
1433450	PRT-400 XPG	0.38	450	20 PCE
1433451	PRT-500 XPG	0.47	550	20 PCE
1433452	PRT-600 XPG	0.56	650	20 PCE
XPG	Manufactured of coated steel in accordance with standard EN 10346 : C1-C4			

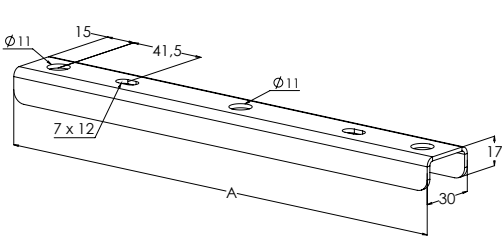

Low voltage gutter SR

Low voltage gutters SR are used to separate cables within cable ladders, cable trays and wire mesh trays.

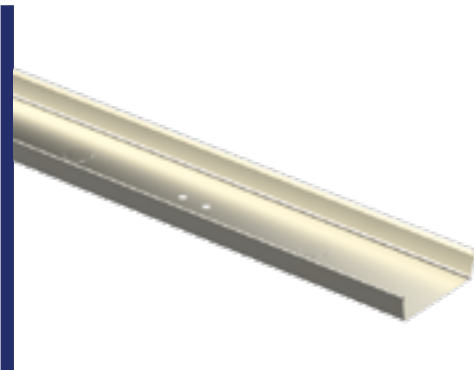

CODE	PRODUCT	WEIGHT kg / pc	A mm	L mm	PACKAGE
1433463	SR-50 L=2000 XPG	0.77	50	2000	10 PCE / 20 MTR
1433464	SR-100 L=2000 XPG	1.13	100	2000	10 PCE / 20 MTR
1433465	SR-150 L=2000 XPG	1.53	150	2000	10 PCE / 20 MTR
XPG	Manufactured of coated steel in accordance with standard EN 10346 : C1-C4				

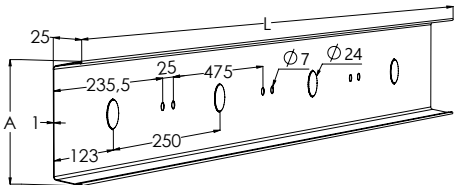

Mounting plate DPA



Mounting plates DPA are used to mount junction boxes and other devices to KS-type cable ladders.

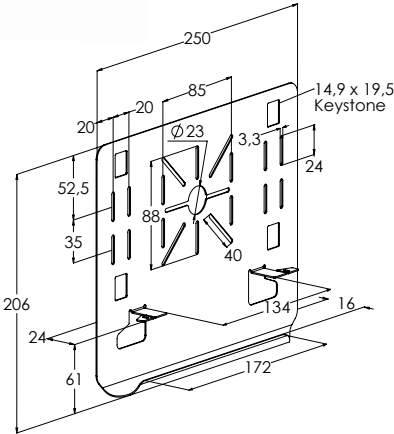
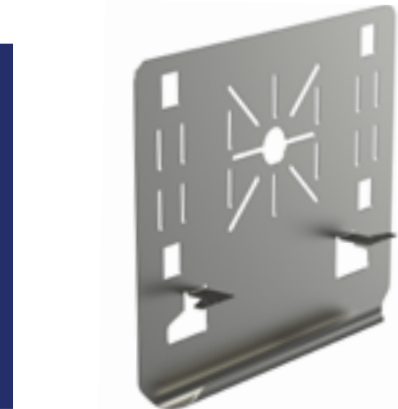

CODE	PRODUCT	WEIGHT kg / pc	PACKAGE
1433444	DPA XPG	0.41	10 PCE
XPG	Manufactured of coated steel in accordance with standard EN 10346 : C1-C4		

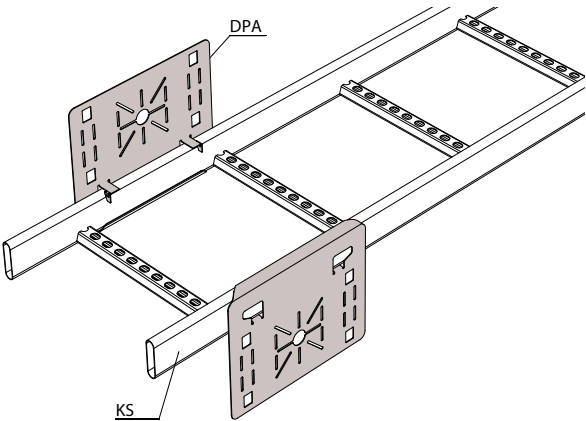

Mounting plate DPA is used to attach junction boxes, switch boxes and the like to a cable ladder's side tubes. The mounting plate is attached to the cable ladder by bending the attaching hooks. Secure the joint with screws, if necessary.



Mounting plate DPA-O

Mounting plates DPA-O are used to mount junction boxes and other devices to KS-type cable ladders.

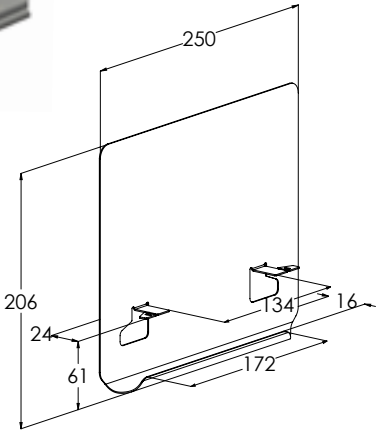

CODE	PRODUCT	WEIGHT kg / pc	PACKAGE
1433445	DPA-O XPG	0.41	10 PCE
XPG	Manufactured of coated steel in accordance with standard EN 10346 : C1-C4		

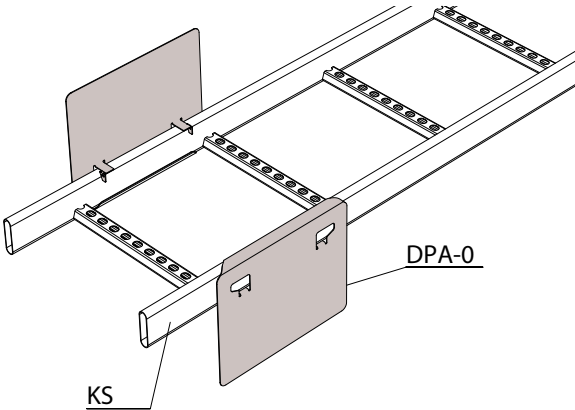

Mounting plate DPA-O is used to attach junction boxes, switch boxes and the like to a cable ladder's side tubes. The mounting plate is attached to the cable ladder by bending the attaching hooks. Secure the joint with screws, if necessary.



Mounting plate DPB



Mounting plates DPB are used to mount junction boxes and other devices to KS-type cable ladders.

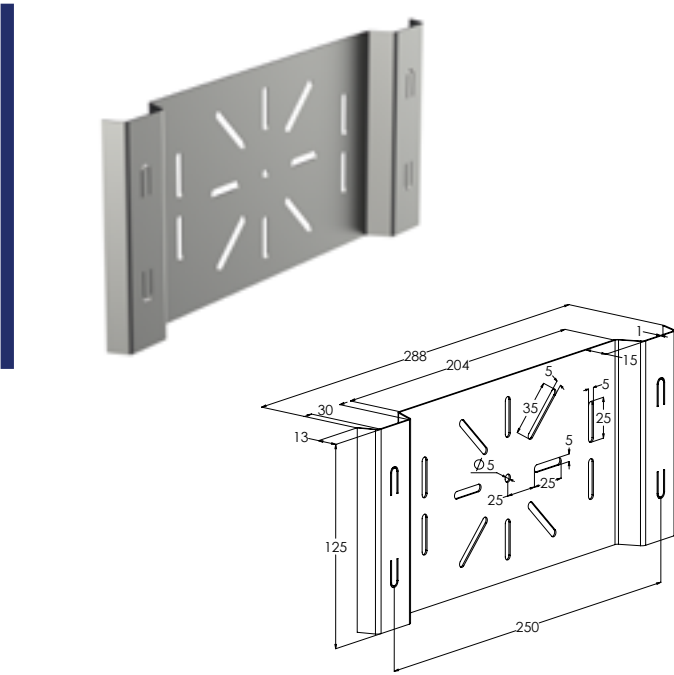

CODE	PRODUCT	WEIGHT kg / pc	PACKAGE
1433446	DPB XPG	0.29	10 PCE
XPG	Manufactured of coated steel in accordance with standard EN 10346 : C1-C4		

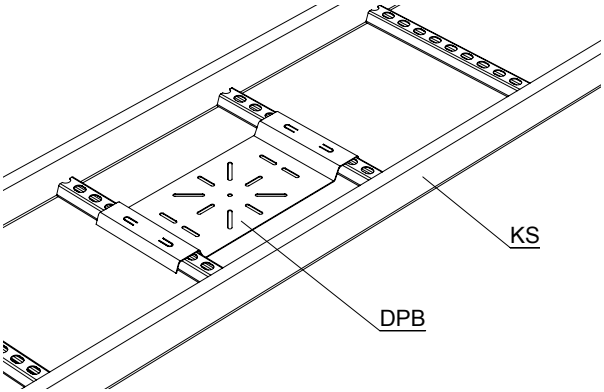

Mounting plate DPB is used to attach junction boxes, switch boxes and the like to a cable ladder's side cleats. The mounting plate is attached to the cable ladder by bending the attaching hooks into the intermediate cleat's holes.



Mounting plate DPB-O

Mounting plates DPB-O are used to mount junction boxes and other devices to KS-type cable ladders.

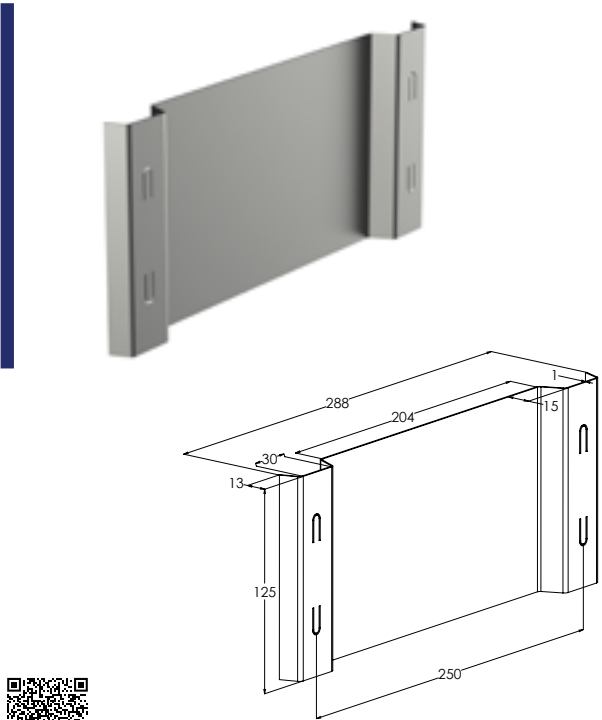

CODE	PRODUCT	WEIGHT kg / pc	PACKAGE
1433447	DPB-O XPG	0.3	10 PCE
XPG	Manufactured of coated steel in accordance with standard EN 10346 : C1-C4		

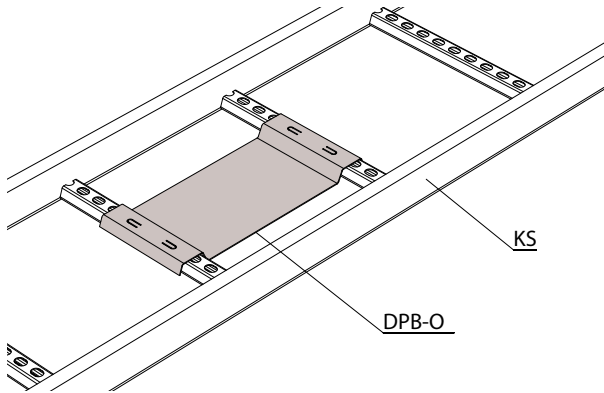

Mounting plate DPB-O is used to attach junction boxes, switch boxes and the like to a cable ladder's side cleats. The mounting plate is attached to the cable ladder by bending the attaching hooks into the intermediate cleat's holes.



Mounting plate KL



Mounting plates KL are used to mount junction boxes and other devices to KS-type cable ladders as well as to protect cables from damage.

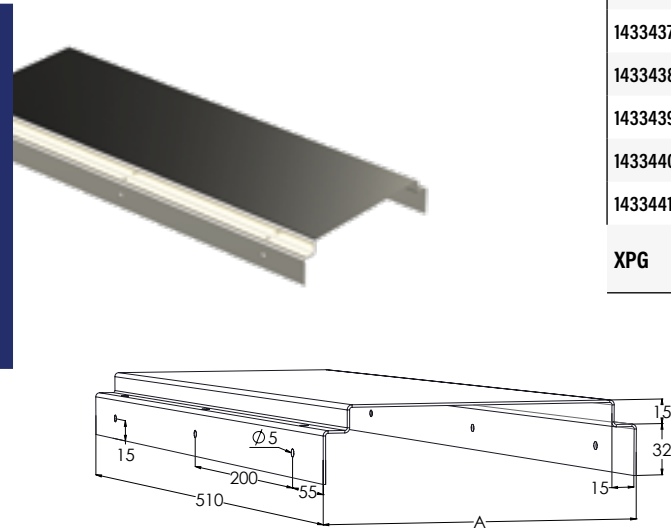

CODE	PRODUCT	WEIGHT kg / pc	A mm	PACKAGE
1433436	KL-150 L=510 XPG	1.38	153	10 PCE
1433437	KL-200 L=510 XPG	1.67	203	10 PCE
1433438	KL-300 L=510 XPG	2.27	303	10 PCE
1433439	KL-400 L=510 XPG	2.85	403	10 PCE
1433440	KL-500 L=510 XPG	3.44	503	10 PCE
1433441	KL-600 L=510 XPG	4.04	603	10 PCE
XPG	Manufactured of coated steel in accordance with standard EN 10346 : C1-C4			

Mounting plate KL is used to attach various appliances, such as frequency modulators and switches.

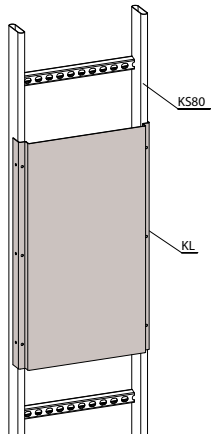

Branching sheet AG

Branching sheets AG are used to support cables when VF brackets are used for making T-connections of KS-type cable ladders.

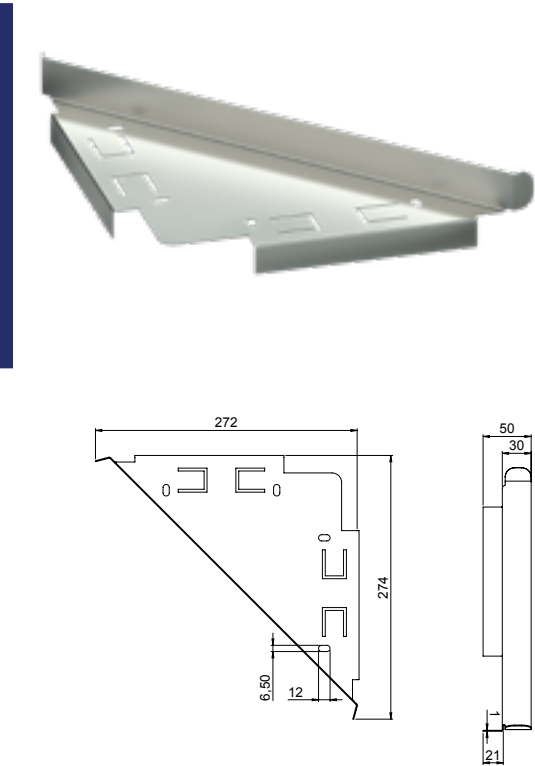

CODE	PRODUCT	WEIGHT kg / pc	A mm	PACKAGE
1433443	AG XPG	0.36	275	10 PCE
XPG	Manufactured of coated steel in accordance with standard EN 10346 : C1-C4			

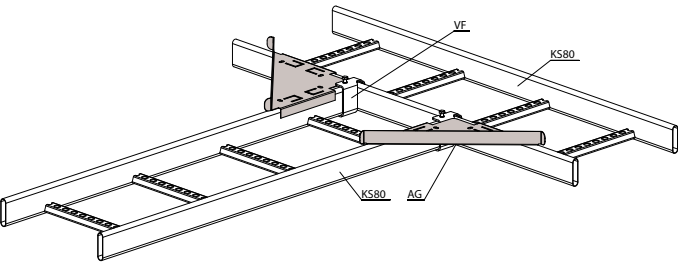

Cable trays



Cable tray CT-E

Perforated cable trays are used in places where cables have to be protected underneath. Perforation enhances airflow and cools the cables installed on the tray. Typically used in office- and commercial buildings, schools, hospitals and shopping centres but also in warehouses, parking halls and industrial buildings. CT-E cable trays have integrated joint part and for connection only bolt sets RS 5 or brackets CT-QL are needed.

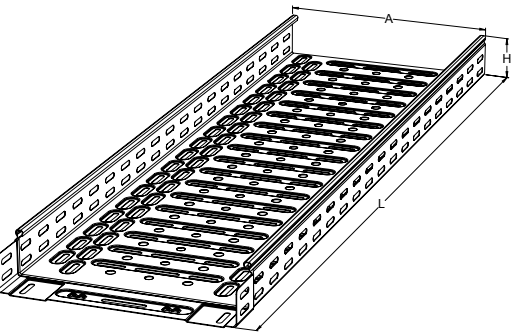

CODE	PRODUCT	WEIGHT kg / pc	A mm	H mm	L mm	S mm	PACKAGE
1461600	CT-E-35-100 L=3000 XPG	3.13	100	39	3000	0.75	12 PCE / 36 MTR
1461601	CT-E-35-200 L=3000 XPG	4.59	200	39	3000	0.75	6 PCE / 18 MTR
1461602	CT-E-35-300 L=3000 XPG	6.1	300	39	3000	0.75	6 PCE / 18 MTR
1461603	CT-E-35-400 L=3000 XPG	10.19	400	39	3000	1	6 PCE / 18 MTR
1461604	CT-E-35-500 L=3000 XPG	12.3	500	39	3000	1	6 PCE / 18 MTR
1461605	CT-E-35-600 L=3000 XPG	14.41	600	39	3000	1	6 PCE / 18 MTR
1461606	CT-E-60-100 L=3000 XPG	3.88	100	64	3000	0.75	8 PCE / 24 MTR
1461607	CT-E-60-200 L=3000 XPG	5.34	200	64	3000	0.75	8 PCE / 24 MTR
1461608	CT-E-60-300 L=3000 XPG	6.85	300	64	3000	0.75	4 PCE / 12 MTR
1461609	CT-E-60-400 L=3000 XPG	11.19	400	64	3000	1	4 PCE / 12 MTR
1461610	CT-E-60-500 L=3000 XPG	13.31	500	64	3000	1	4 PCE / 12 MTR
1461611	CT-E-60-600 L=3000 XPG	15.42	600	64	3000	1	4 PCE / 12 MTR
1461612	CT-E-85-100 L=3000 XPG	4.63	100	89	3000	0.75	8 PCE / 24 MTR
1461613	CT-E-85-200 L=3000 XPG	6.09	200	89	3000	0.75	8 PCE / 24 MTR
1461614	CT-E-85-300 L=3000 XPG	7.6	300	89	3000	0.75	4 PCE / 12 MTR
1461615	CT-E-85-400 L=3000 XPG	12.2	400	89	3000	1	4 PCE / 12 MTR
1461616	CT-E-85-500 L=3000 XPG	14.31	500	89	3000	1	4 PCE / 12 MTR
1461617	CT-E-85-600 L=3000 XPG	16.42	600	89	3000	1	4 PCE / 12 MTR
XPG	Manufactured of coated steel in accordance with standard EN 10346 : C1-C4						

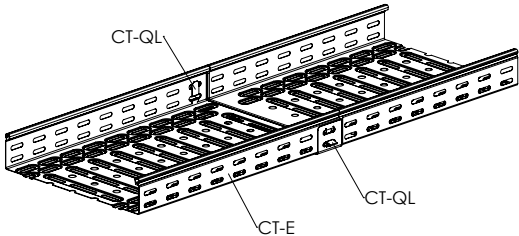
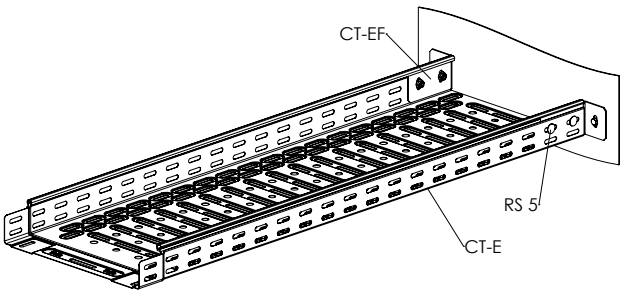

Cable tray CT-PS



Perforated cable trays are used in places where cables have to be protected underneath. Perforation enhances airflow and cools the cables installed on the tray. Typically used in office- and commercial buildings, schools, hospitals and shopping centres but also in warehouses, parking halls and industrial buildings.

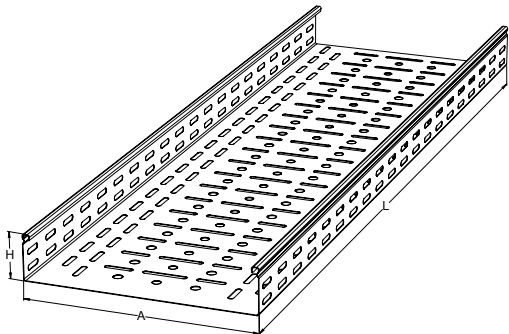

CODE	PRODUCT	WEIGHT kg / pc	A mm	H mm	L mm	S mm	PACKAGE
1461624	CT-PS-35-50 L=3000 XPG	2.4	50	35	3000	0.75	18 PCE / 54 MTR
1461625	CT-PS-35-75 L=3000 XPG	2.84	75	35	3000	0.75	18 PCE / 54 MTR
1461632	CT-PS-60-50 L=3000 XPG	3.15	50	60	3000	0.75	12 PCE / 36 MTR
1461633	CT-PS-60-75 L=3000 XPG	3.59	75	60	3000	0.75	12 PCE / 36 MTR
1461634	CT-PS-60-100 L=3000 XPG	3.89	100	60	3000	1	8 PCE / 24 MTR
1461635	CT-PS-60-200 L=3000 XPG	5.35	200	60	3000	1	8 PCE / 24 MTR
1461636	CT-PS-60-300 L=3000 XPG	6.86	300	60	3000	1	4 PCE / 12 MTR
1461637	CT-PS-60-400 L=3000 XPG	11.21	400	60	3000	1.5	4 PCE / 12 MTR
1461638	CT-PS-60-500 L=3000 XPG	13.32	500	60	3000	1.5	4 PCE / 12 MTR
1461639	CT-PS-60-600 L=3000 XPG	15.43	600	60	3000	1.5	4 PCE / 12 MTR
1461640	CT-PS-85-100 L=3000 XPG	4.65	100	85	3000	1	8 PCE / 24 MTR
1461641	CT-PS-85-200 L=3000 XPG	6.11	200	85	3000	1	8 PCE / 24 MTR
1461642	CT-PS-85-300 L=3000 XPG	7.61	300	85	3000	1	4 PCE / 12 MTR
1461643	CT-PS-85-400 L=3000 XPG	12.21	400	85	3000	1.5	4 PCE / 12 MTR
1461644	CT-PS-85-500 L=3000 XPG	14.33	500	85	3000	1.5	4 PCE / 12 MTR
1461645	CT-PS-85-600 L=3000 XPG	16.44	600	85	3000	1.5	4 PCE / 12 MTR
XPG	Manufactured of coated steel in accordance with standard EN 10346 : C1-C4						

Cable tray CT-US



Cable trays, non-perforated, are used in places where cables have to be totally invisible and protected underneath. Typically used in office- and commercial buildings, schools, hospitals and shopping centres but also in warehouses, parking halls and industrial buildings.

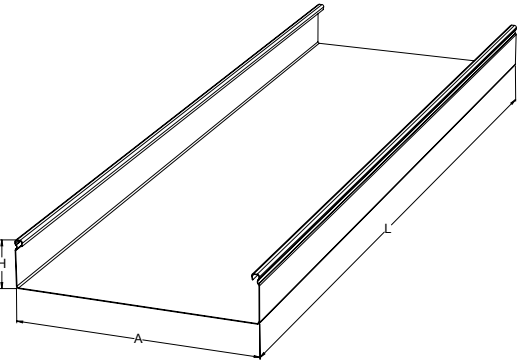

CODE	PRODUCT	WEIGHT kg / pc	A mm	H mm	L mm	S mm	PACKAGE
1461670	CT-US-60-50 L=3000 XPG	3.43	50	60	3000	0.75	12 PCE / 36 MTR
1461671	CT-US-60-75 L=3000 XPG	3.87	75	60	3000	0.75	12 PCE / 36 MTR
1461672	CT-US-60-100 L=3000 XPG	4.31	100	60	3000	1.5	8 PCE / 24 MTR
1461673	CT-US-60-200 L=3000 XPG	6.07	200	60	3000	1.5	8 PCE / 24 MTR
1461674	CT-US-60-300 L=3000 XPG	7.82	300	60	3000	1.5	4 PCE / 12 MTR
1461675	CT-US-60-400 L=3000 XPG	12.72	400	60	3000	1.5	4 PCE / 12 MTR
1461676	CT-US-60-500 L=3000 XPG	15.06	500	60	3000	1.5	4 PCE / 12 MTR
1461677	CT-US-60-600 L=3000 XPG	17.4	600	60	3000	1.5	4 PCE / 12 MTR
1461680	CT-US-85-300 L=3000 XPG	8.7	300	85	3000	1.5	8 PCE / 24 MTR
1461681	CT-US-85-400 L=3000 XPG	13.89	400	85	3000	1.5	8 PCE / 24 MTR
1461682	CT-US-85-500 L=3000 XPG	16.23	500	85	3000	1.5	4 PCE / 12 MTR
1461683	CT-US-85-600 L=3000 XPG	18.57	600	85	3000	1.5	4 PCE / 12 MTR
XPG	Manufactured of coated steel in accordance with standard EN 10346 : C1-C4						

Joint CT-SC



Joints CT-SC are used to extend cable trays CT-PS and CT-US.

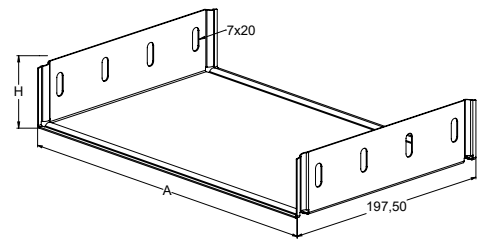

CODE	PRODUCT	WEIGHT kg / pc	A mm	H mm	PACKAGE
1470836	CT-SC-35-50 XPG	0.13	47	33	10 PCE
1470837	CT-SC-35-75 XPG	0.16	72	33	10 PCE
1470838	CT-SC-35-100 XPG	0.2	97	33	10 PCE
1470839	CT-SC-35-200 XPG	0.33	197	33	10 PCE
1470840	CT-SC-35-300 XPG	0.48	297	33	10 PCE
1470844	CT-SC-60-50 XPG	0.21	47	58	10 PCE
1470845	CT-SC-60-75 XPG	0.24	72	58	10 PCE
1470846	CT-SC-60-100 XPG	0.27	97	58	10 PCE
1470847	CT-SC-60-200 XPG	0.41	197	58	10 PCE
1470848	CT-SC-60-300 XPG	0.56	297	58	10 PCE
1470849	CT-SC-60-400 XPG	0.9	397	58	10 PCE
1470850	CT-SC-60-500 XPG	1.09	497	58	10 PCE
1470851	CT-SC-60-600 XPG	1.29	597	58	10 PCE
XPG	Manufactured of coated steel in accordance with standard EN 10346 : C1-C4				

Joint CT-SC is pushed inside the cable tray and attached with the screw set RS 5.

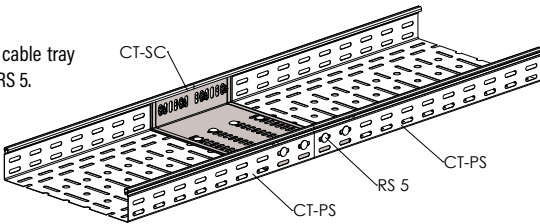

Joint CT-SCS

Joints CT-SCS are used to extend cable trays CT-PS and CT-US.

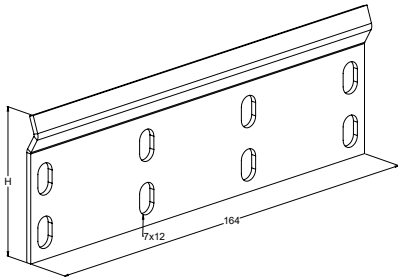
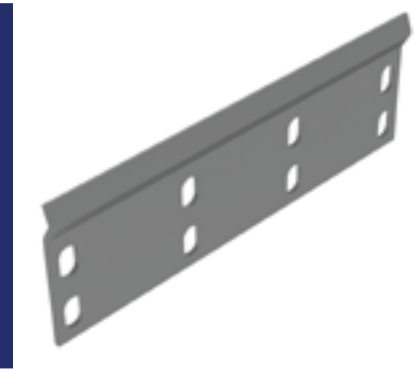

CODE	PRODUCT	WEIGHT kg / pc	H mm	PACKAGE
1470864	CT-SCS-35 XPG	0.072	31	10 PCE
1470865	CT-SCS-60 XPG	0.12	56	10 PCE
XPG	Manufactured of coated steel in accordance with standard EN 10346 : C1-C4			

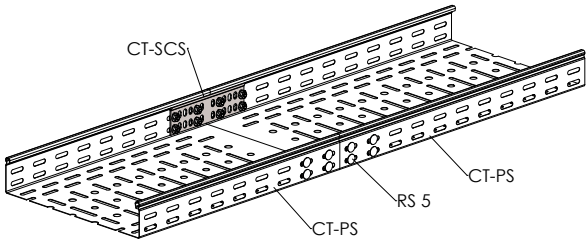

Corner piece CT-LP

Corner pieces CT-LP are used to make a 90° angles for CT-type cable trays.

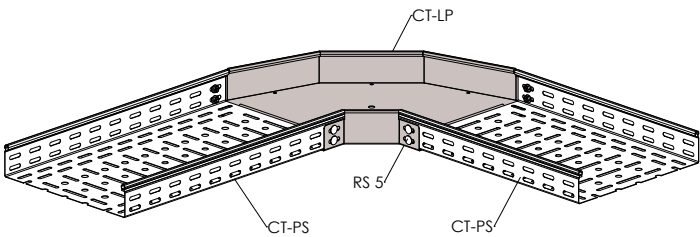
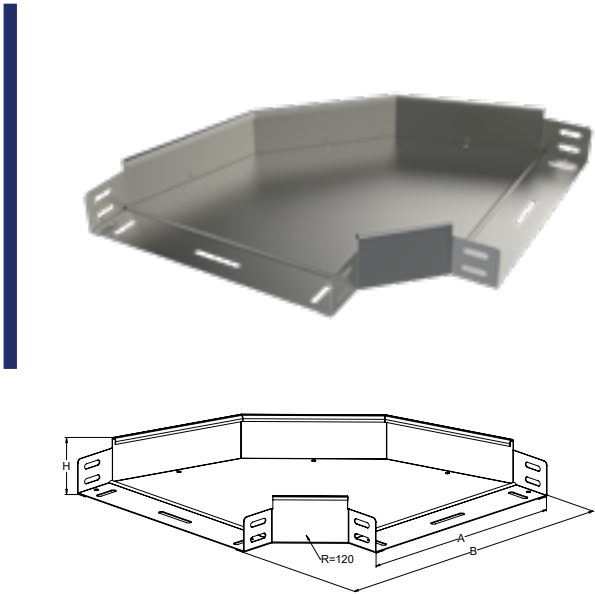

Joint CT-SC is pushed inside the cable tray and attached with the screw set RS 5.

T-piece CT-TP

T-pieces CT-TP are used to make T-junctions for CT-type cable trays.

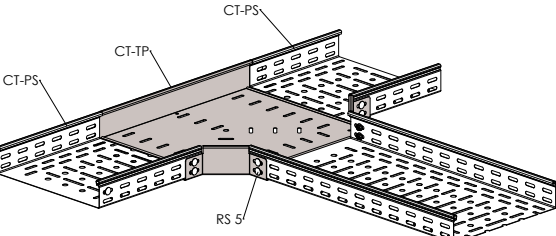
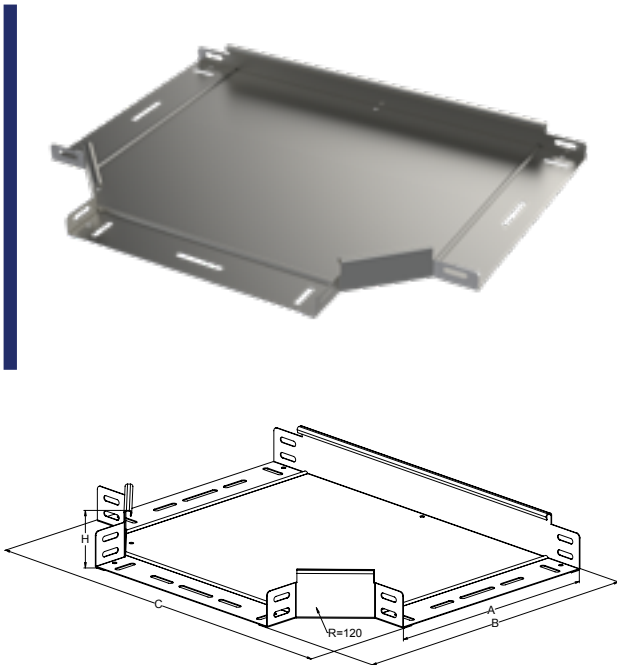

CODE	PRODUCT	WEIGHT kg / pc	A mm	B mm	PACKAGE
1470868	CT-LP-35-50 XPG	0.1	117	117	1 PCE
1470869	CT-LP-35-75 XPG	0.14	142	142	1 PCE
1470870	CT-LP-35-100 XPG	0.45	222	222	1 PCE
1470871	CT-LP-35-200 XPG	0.85	322	322	1 PCE
1470872	CT-LP-35-300 XPG	1.37	422	422	1 PCE
1470876	CT-LP-60-50 XPG	0.16	117	117	1 PCE
1470877	CT-LP-60-75 XPG	0.2	142	142	1 PCE
1470878	CT-LP-60-100 XPG	0.54	222	222	1 PCE
1470879	CT-LP-60-200 XPG	0.97	322	322	1 PCE
1470880	CT-LP-60-300 XPG	1.51	422	422	1 PCE
1470881	CT-LP-60-400 XPG	2.16	522	522	1 PCE
1470882	CT-LP-60-500 XPG	4.11	622	622	1 PCE
1470883	CT-LP-60-600 XPG	5.41	722	722	1 PCE
XPG	Manufactured of coated steel in accordance with standard EN 10346 : C1-C4				

Vertical bend, inside CT-VU

Vertical bends CT-VU are used to make 90° angles for cable trays CT. CT-VU radius is R=200 mm.

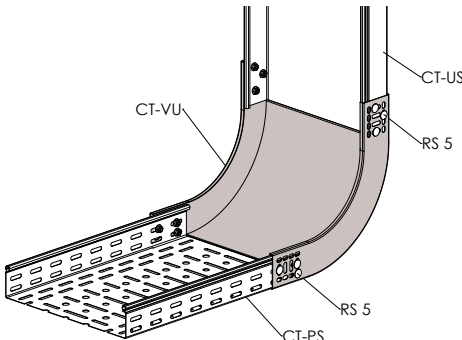
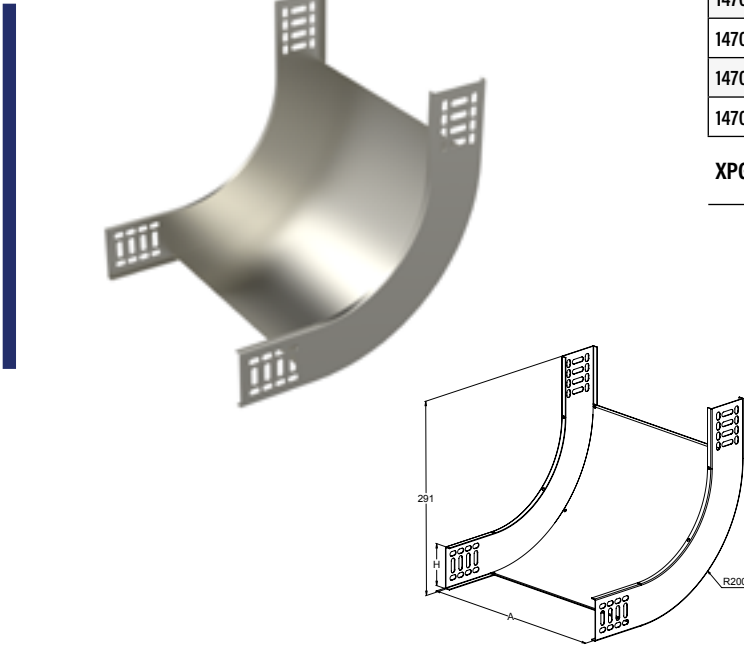

CODE	PRODUCT	WEIGHT kg / pc	A mm	H mm	PACKAGE
1470976	CT-VU-60-100 XPG	0.75	104	291	1 PCE
1470977	CT-VU-60-200 XPG	1.01	204	291	1 PCE
1470978	CT-VU-60-300 XPG	1.26	304	291	1 PCE
1470979	CT-VU-60-400 XPG	1.51	404	291	1 PCE
1470980	CT-VU-60-500 XPG	1.76	504	291	1 PCE
1470981	CT-VU-60-600 XPG	2.01	604	291	1 PCE
XPG	Manufactured of coated steel in accordance with standard EN 10346 : C1-C4				

Vertical bend, outside CT-VD

Vertical bends CT-VD are used to make 90° angles for cable trays CT. CT-VD radius depends on edge height.

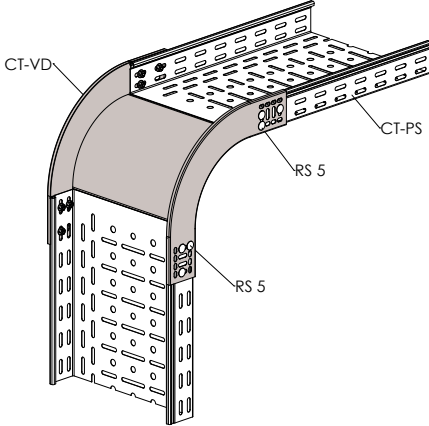
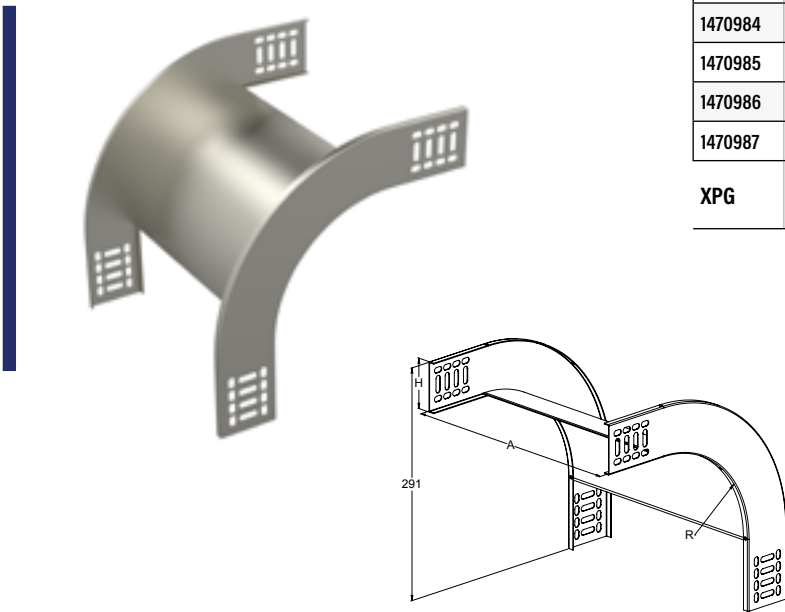

CODE	PRODUCT	WEIGHT kg / pc	A mm	H mm	R mm	PACKAGE
1470982	CT-VD-60-100 XPG	0.68	104	291	63	1 PCE
1470983	CT-VD-60-200 XPG	0.86	204	291	63	1 PCE
1470984	CT-VD-60-300 XPG	1.03	304	291	63	1 PCE
1470985	CT-VD-60-400 XPG	1.21	404	291	63	1 PCE
1470986	CT-VD-60-500 XPG	1.39	504	291	63	1 PCE
1470987	CT-VD-60-600 XPG	1.56	604	291	63	1 PCE
XPG	Manufactured of coated steel in accordance with standard EN 10346 : C1-C4					

Cover CT-C



Covers CT-C protect the cables from damage, dirt and UV radiation as well as finishes the installation for CT-type cable trays’ straight sections.

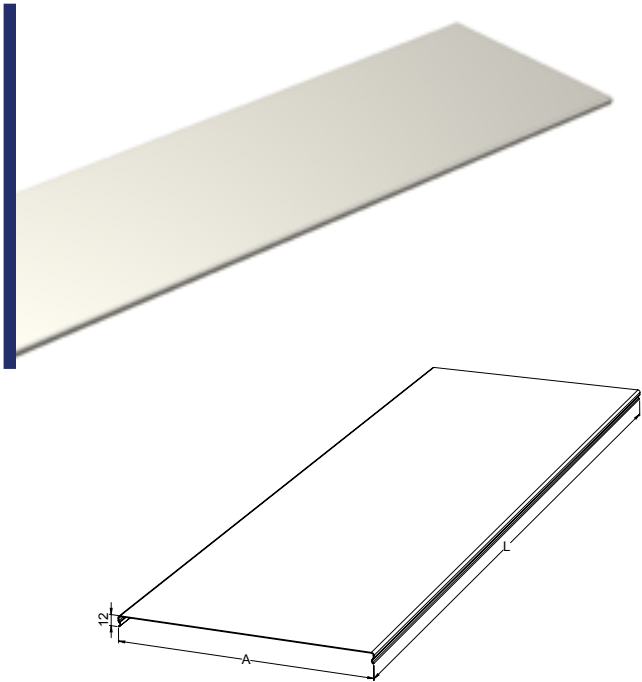

CODE	PRODUCT	WEIGHT kg / pc	A mm	L mm	PACKAGE
1470828	CT-C-50 L=3000 XPG	1.36	53	3000	10 PCE / 30 MTR
1470829	CT-C-75 L=3000 XPG	1.81	78	3000	10 PCE / 30 MTR
1470830	CT-C-100 L=3000 XPG	2.25	103	3000	10 PCE / 30 MTR
1470831	CT-C-200 L=3000 XPG	4.02	203	3000	10 PCE / 30 MTR
1470832	CT-C-300 L=3000 XPG	5.8	303	3000	10 PCE / 30 MTR
1470833	CT-C-400 L=3000 XPG	10.1	403	3000	10 PCE / 30 MTR
1470834	CT-C-500 L=3000 XPG	12.4	503	3000	10 PCE / 30 MTR
1470835	CT-C-600 L=3000 XPG	14.7	603	3000	10 PCE / 30 MTR
XPG	Manufactured of coated steel in accordance with standard EN 10346 : C1-C4				

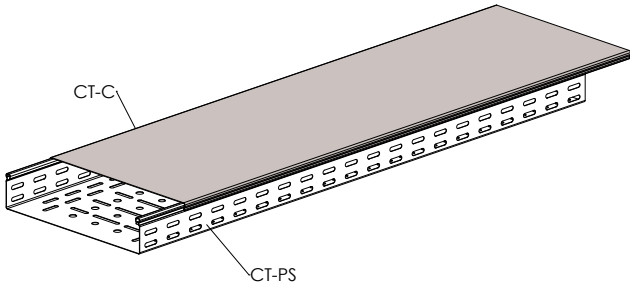

Cover CT-LC

Covers CT-LC protect the cables from damage, dirt and UV radiation as well as finishes the installation for CT-LP corner pieces.

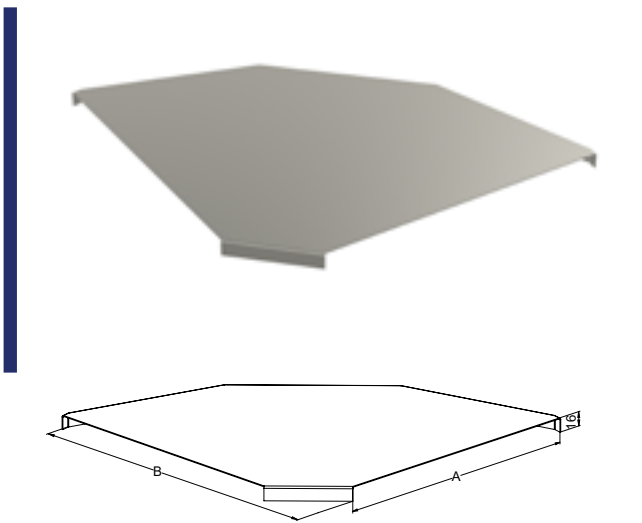

CODE	PRODUCT	WEIGHT kg / pc	A mm	B mm	PACKAGE
1470923	CT-LC-50 XPG	0.045	69	69	1 PCE
1470924	CT-LC-75 XPG	0.079	94	94	1 PCE
1470925	CT-LC-100 XPG	0.21	175	175	1 PCE
1470926	CT-LC-200 XPG	0.49	275	275	1 PCE
1470927	CT-LC-300 XPG	0.89	375	375	1 PCE
1470928	CT-LC-400 XPG	2.11	475	475	1 PCE
1470929	CT-LC-500 XPG	3.05	575	575	1 PCE
1470930	CT-LC-600 XPG	4.18	675	675	1 PCE
XPG	Manufactured of coated steel in accordance with standard EN 10346 : C1-C4				

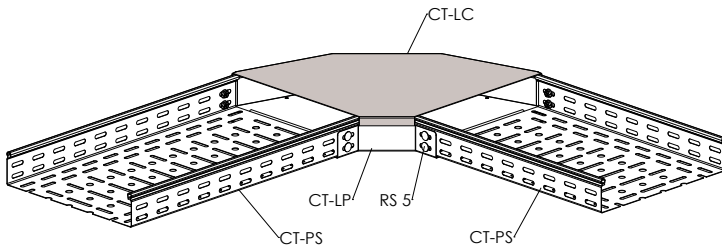

Cover CT-TC



Covers CT-TC protect the cables from damage, dirt and UV radiation as well as finishes the installation for CT-TP T-pieces.

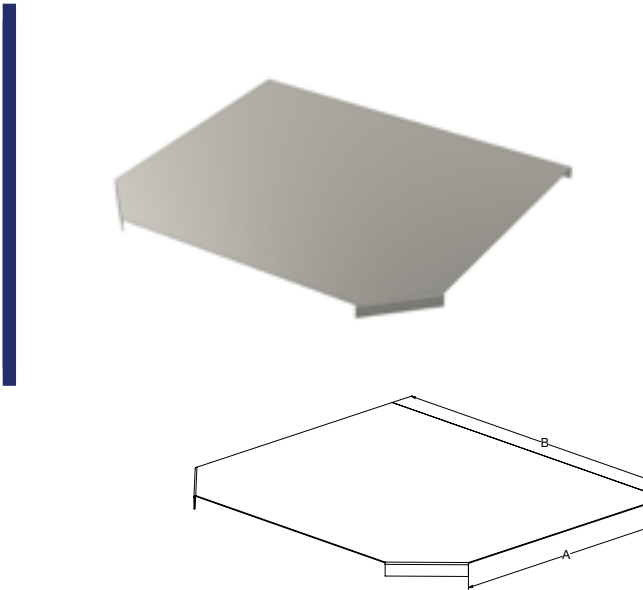

CODE	PRODUCT	WEIGHT kg / pc	A mm	B mm	PACKAGE
1470931	CT-TC-50 XPG	0.053	88	69	1 PCE
1470932	CT-TC-75 XPG	0.09	113	94	1 PCE
1470933	CT-TC-100 XPG	0.35	177	240	1 PCE
1470934	CT-TC-200 XPG	0.77	277	340	1 PCE
1470935	CT-TC-300 XPG	1.34	377	440	1 PCE
1470936	CT-TC-400 XPG	3.11	478	540	1 PCE
1470937	CT-TC-500 XPG	4.44	578	640	1 PCE
1470938	CT-TC-600 XPG	6.01	678	740	1 PCE
XPG	Manufactured of coated steel in accordance with standard EN 10346 : C1-C4				

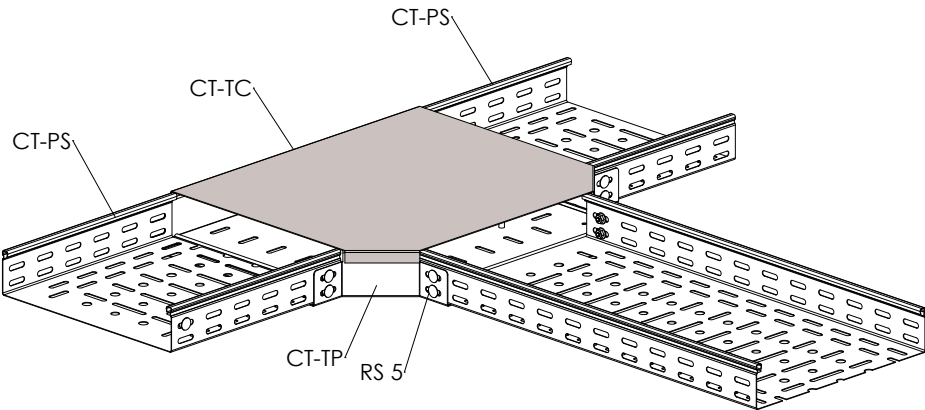

Cover CT-VUC



Covers CT-VUC protect the cables from damage, dirt and UV radiation as well as finishes the installation for CT-VU vertical bends.

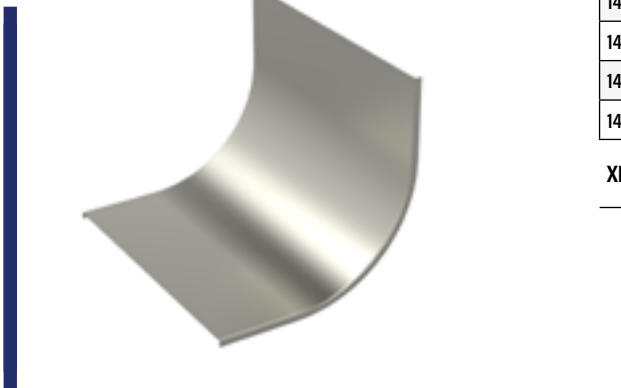

CODE	PRODUCT	WEIGHT kg / pc	A mm	B mm	R mm	PACKAGE
1470988	CT-VUC-60-100 XPG	0.38	108	234	137	1 PCE
1470989	CT-VUC-60-200 XPG	0.69	208	234	137	1 PCE
1470990	CT-VUC-60-300 XPG	1	308	234	137	1 PCE
1470991	CT-VUC-60-400 XPG	1.31	408	234	137	1 PCE
1470992	CT-VUC-60-500 XPG	1.62	508	234	137	1 PCE
1470993	CT-VUC-60-600 XPG	1.93	608	234	137	1 PCE
XPG	Manufactured of coated steel in accordance with standard EN 10346 : C1-C4					

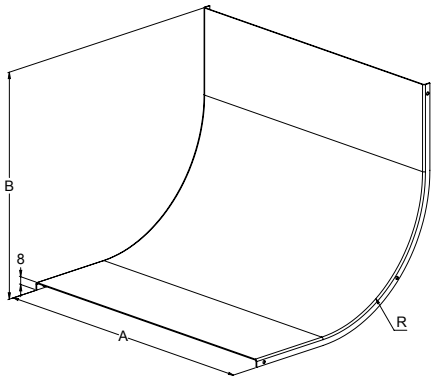
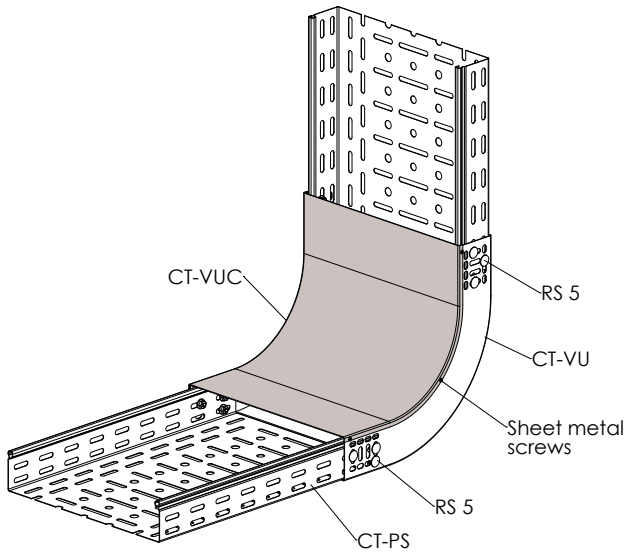

Cover CT-VDC



Covers CT-VDC protect the cables from damage, dirt and UV radiation as well as finishes the installation for CT-VD vertical bends.

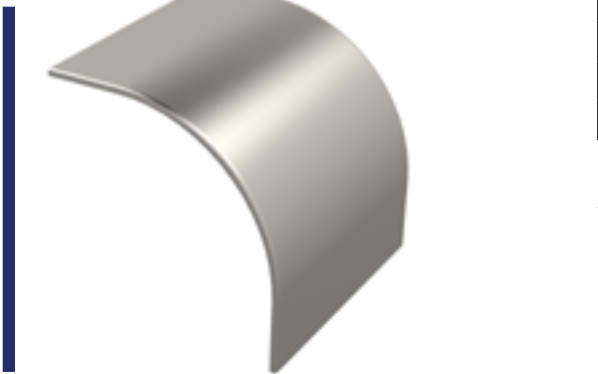

CODE	PRODUCT	WEIGHT kg / pc	A mm	B mm	R mm	PACKAGE
1470994	CT-VDC-60-100 XPG	0.47	108	292	201	1 PCE
1470995	CT-VDC-60-200 XPG	0.87	208	292	201	1 PCE
1470996	CT-VDC-60-300 XPG	1.26	308	292	201	1 PCE
1470997	CT-VDC-60-400 XPG	1.65	408	292	201	1 PCE
1470998	CT-VDC-60-500 XPG	2.04	508	292	201	1 PCE
1470999	CT-VDC-60-600 XPG	2.43	608	292	201	1 PCE
XPG	Manufactured of coated steel in accordance with standard EN 10346 : C1-C4					

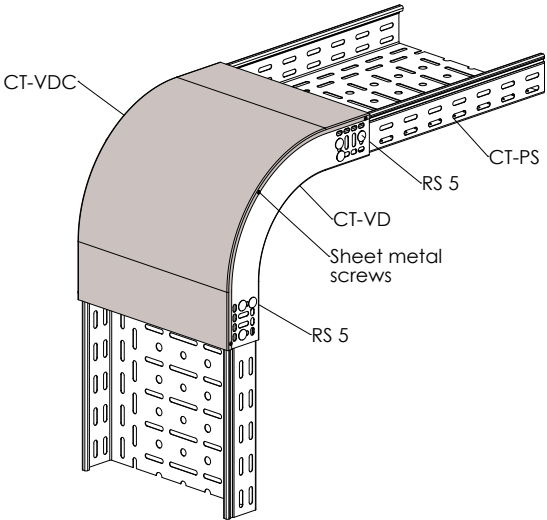
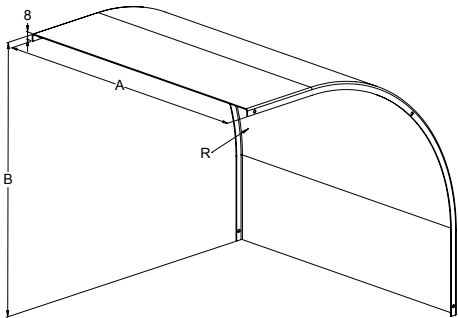



Meka's XPG coating is a cost-effective option to hot-dip galvanized products.



Konetie 25, FI-90620 Oulu
+358 207 450 800
meke@meke.eu
www.meke.eu

This catalogue is released in February 2022. Due to development of production and products there might be changes in product range and technical data. These changes could be made by the manufacturer without notice. For up-to-date information please contact our representatives in your area or the technical department of Meka Pro Oy factory.